

Rils, Rilhs



Use:

Wagon with fixed front walls and sliding sheet cover is intended to carry large volume lump commodities, long objects, machinery, smelting, wood and building materials requiring weather, damage and property protection. This advantage of this wagon is the possibility to use any mechanical device when loading and unloading and safe opening roof handling.



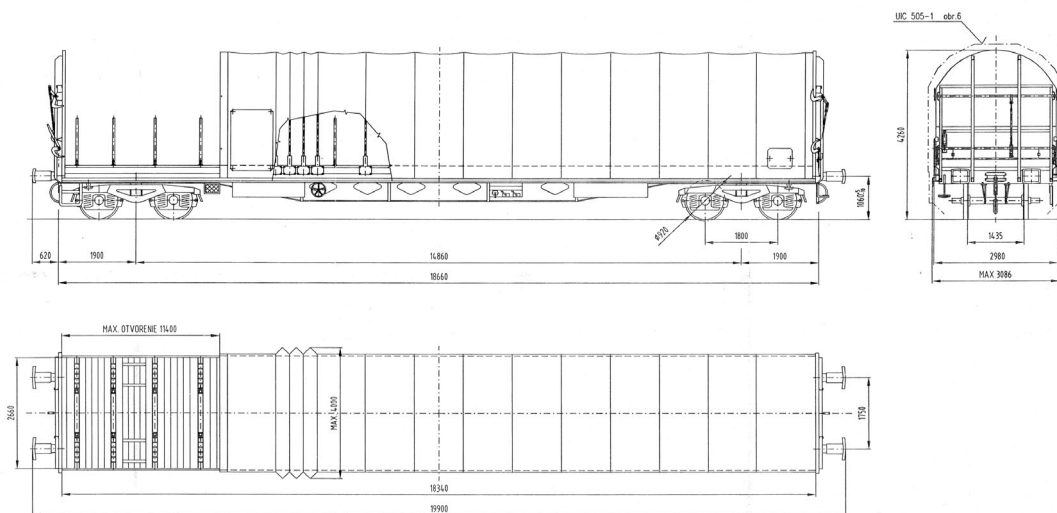

Wagon technical parameters

Wagon series		Rils	Rilhs		
Digit interval		3537 - 3538	3536		
Construction group		51, 67	51		
Interoperability		31	31		
Number of axles		4	4		
Bogie type		Y 25	Y 25		
Wagon length over the buffers		19,90 m	19,90 m		
Wagon tare		24,00 t	25,20 t		
Loading capacity	A	40,00 t	39,00 t		
	B	48,00 t	47,00 t		
	C	56,00 t	54,50 t		
Loading length		18,53 m	18,53 m		
Loading width		2,66 m	2,66 m		
Loading surface		49,30 m ²	49,30 m ²		
Loading height (max.)		2,40 m	2,40 m		
Distance between floor and USR		1,23 m	1,23 m		
Axle base / pivot pins distance		14,86 m	14,86 m		
Loading volume		99,00 m ³	104,00 m ³		
Maximum loading capacity for evenly distributed freight			[m]	[t]	Δ Δ
		a-a	2	32	33
		b-b	5	35	38
		c-c	9	36	44
		d-d	15	44	54,5
e-e	18	54,5	24		
Note					